

Check Valve / S70

NPS 2 - 30
Cl. 150 / 300

Figure S70.054 (Class 150)
Figure S70.056 (Class 300)

Design

1. The valve is designed in accordance with BS 1868.
2. The painting, protection and marking of the valve shall be in accordance with MSS SP-25.

Dimensions

Cl. 150	NPS	2	2 1/2	3	4	5	6	8	10	12
	L_{RF/BW}	203	216	241	292	330	356	495	622	699
	L_{RTJ}	216	229	254	305	349	368	508	635	711
	H	170	180	185	215	240	260	300	389,5	437,5
	Weight_{RF} (kg)	15	26	27	42	69	75	124	177	263
	Weight_{BW} (kg)	12	17	18	32	57	60	106	143	227

Cl. 150	NPS	14	16	18	20	24	26	28	30
	L_{RF/BW}	787	864	978	978	1295	1295	1448	1524
	L_{RTJ}	800	876	991	991	1308	-	-	-
	H	476,5	525	582	627	880	910	935	970
	Weight_{RF} (kg)	353	542	632	855	970	1276	1600	1990
	Weight_{BW} (kg)	294	468	552	755	831	1120	1420	1760

Cl. 300	NPS	2	2 1/2	3	4	5	6	8	10	12
	L_{RF/BW}	267	292	318	356	400	445	533	622	711
	L_{RTJ}	283	308	333	371	416	460	549	638	727
	H	176	185	216	259	304	317	380	434	511
	Weight_{RF} (kg)	20	30	38	64	84	115	191	310	450
	Weight_{BW} (kg)	16	22	30	53	73	101	169	276	414

Cl. 300	NPS	14	16	18	20	24	26	28	30
	L_{RF/BW}	838	864	978	1016	1346	1346	1499	1594
	L_{RTJ}	854	879	994	1035	1369	1372	1524	1619
	H	561	596	675	730	860	930	1163	1270
	Weight_{RF} (kg)	644	840	1025	1320	1931	2375	2660	3230
	Weight_{BW} (kg)	585	766	945	1220	1792	1995	2260	2780

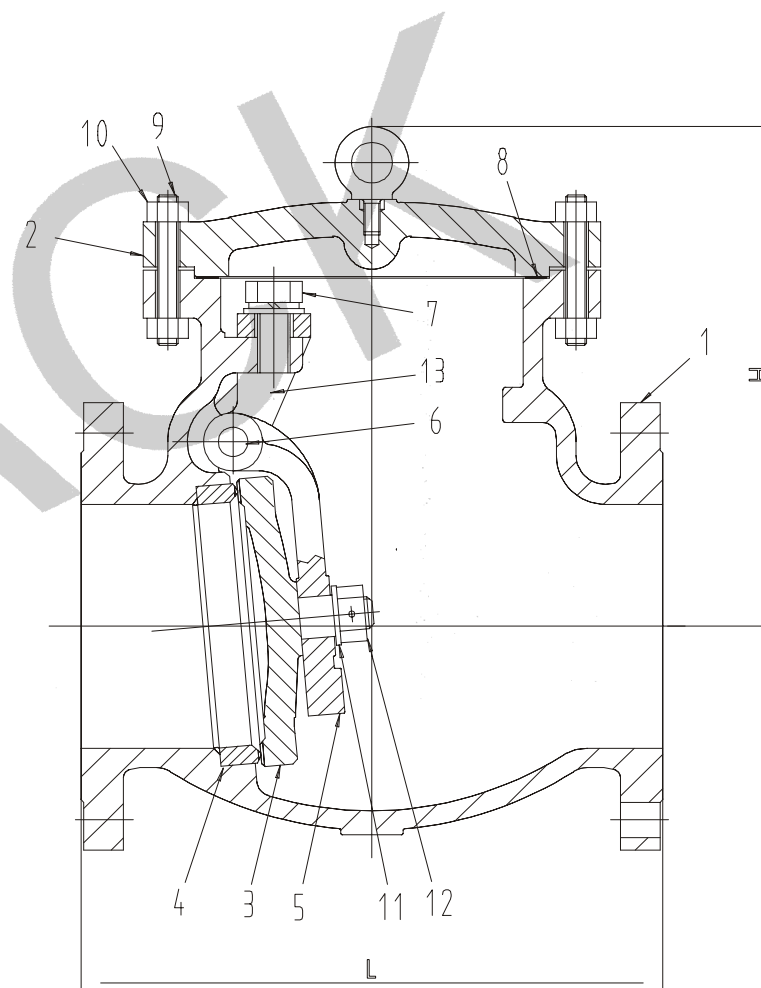

S70.054 / S70.056

Materials

Item	Part name	Heat resistant carbon steel			Low temperature steel	Stainless steel
		Material up to 400°C	Material from -10°C up to 550°C	Material from -10°C up to 500°C	Material from -50°C up to 300°C	Material from -200°C up to 400°C
1	Body	A 216 WCB	A 217 WC6	A 217 C5	352 LCB	A 351 CF 8M
2	Cover	A 216 WCB	A 217 WC6	A 217 C5	352 LCB	A 351 CF 8M
5	Hinge	A 216 WCB	A 217 WC6	A 217 C5	352 LCB	A 351 CF 8M
7	Plugs	Carbon steel	Stainless steel	Stainless steel	Stainless steel	Stainless steel
8	Gasket	Spiral wound graphite	Spiral wound graphite	Spiral wound graphite	Spiral wound graphite	Spiral wound graphite
9	Bolts	A 193 Gr. B7	A 193 Gr. B16	A 193 Gr. B16	A 193 Gr. B8M	A 193 Gr. B8M
10	Nuts	A 194 Gr. 2H	A 194 Gr. 4	A 194 Gr. 4	A 194 Gr. 8M	A 194 Gr. 8M
11	Washer	Steel	Stainless steel	Stainless steel	Stainless steel	Stainless steel
12	Nuts	Steel	Stainless steel	Stainless steel	Stainless steel	Stainless steel
13	Hook screw	Steel	Steel	Steel	Steel	Steel

Special materials on request.

Specification

Marking	MSS SP-25, ISO 5209 (EN19, AD-A4, CE)
Face-to-face dimensions	
Flanged option	ASME B 16.10
Connections	
Flanged option	ASME B 16.5
Pressure-temp.-rating	ASME B 16.34
Testing standard	API 598, ISO 5208 (AD-2000, DIN 3230 section 3)

Trim material to API 600

Trim N.	Nominal Trim	Wedge seat Surface Part. n. 3	Seat ring surface Part. n. 7	Stem Part. n. 8	Backseat bushing Part. n. 9
1	F6	F6	F6	F6	F6
2	304	F304	F304	F304	F304
5	Hardfaced	Stellite	Stellite	F6	F6
8	F6 and hardfaced	F6	Stellite	F6	F6
9	Monel	Monel	Monel	Monel	Monel
10	316	F316	F316	F316	F316
12	316 and Hardfaced	Stellite	F316	F316	F316
13	Alloy 20	Alloy 20	Alloy 20	Alloy 20	Alloy 20
16	Hardfaced	Stellite	Stellite	F316	F316